

GENERAL INSTRUCTIONS FOR ALL MODELS

MOUNTING

Proper mounting of your scope is important for maximizing performance.

If you intend to do the installation yourself, we recommend that you read these instructions. Should you encounter any problems, contact your firearms dealer or gunsmith, who can be a great source of information.

For maximum performance and reliability from your scope, it should be matched with a mounting base designed for your rifle.

Your firearms dealer or gunsmith can assist you in selecting the correct mounting base for your firearm. Follow the instructions provided with the base for proper installation.

CAUTION: Be sure that your gun is not loaded prior to installing the mounting base. Use safe gun handling procedures at all times.

FOCUSING THE SCOPE

Prior to mounting the scope on your firearm, focus the reticle. Unless the strength of your eye changes, focus needs to be done only once.

Hold the scope about three or four inches from your eye. Quickly glance through the eyepiece at a featureless, flatly lit, bright area, such as a wall.

If the reticle is not sharply defined, then turn the eyepiece all the way in (clockwise). Turn the eyepiece 1/4 turn counterclockwise and quickly glance through the scope again. If the focus is still not sharp, continue focusing.

After focusing, set the scope aside and install the rings on the base.

ATTACHING THE RINGS TO THE BASE

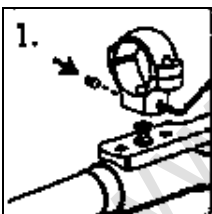

1. Place a ring over the tip of the stud on the base. Tighten the cone screws lightly. Install the second ring and square both rings to the base (Fig. 1).

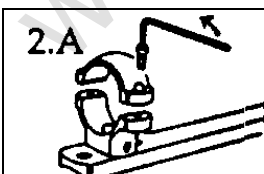

2. Remove ring tops (Fig. 2A).

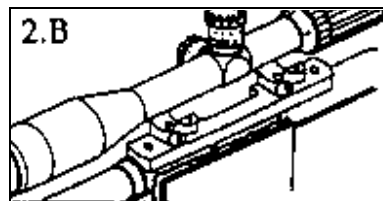

3. Place scope in the ring bottoms (Fig. 2B). Be sure the rings line up with scope without stress or damage to scope.

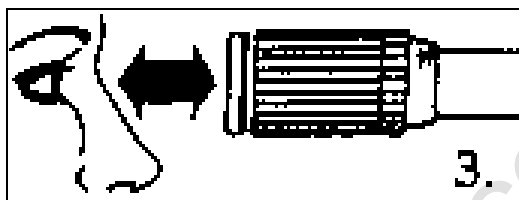

4. Check eye relief (Fig. 3) and reticle position. Move the scope as

far forward in the rings as it will go. Rotate the scope so the elevation turret is on top, taking care not to scratch the scope.

Shoulder or bench rest the rifle and move the scope back toward you until you see the full field of view.

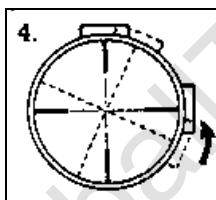

4. Be sure the reticle position is vertical (Fig. 4). The vertical and horizontal crosshairs should be aligned with the bore axis. You can check this with a plumb line or the edge of a target. The target or line should be at least 50 yards away. It

is important that the rifle is not canted at any time during this process.

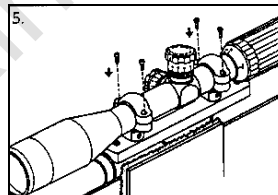

5. When the scope is properly positioned and reticle aligned with bore axis, replace the ring tops and tighten the ring screws completely (Fig. 5).

IMPORTANT: Do not over tighten, as this may mar the scope.

There may be a slight gap (less than 1 mm) between the top and bottom portions of the rings. The gap should be even on the left and right sides of both rings.

PRE-ZEROING

CAUTION: Be sure gun is not loaded. Use safe handling procedures at all times.

Pre-zeroing can be done with a bore sighter.

To bore sight, open the action. Remove the bolt from bolt action guns. If your Tactical Scope has parallax correction, rotate the parallax ring to the 50-yard position

Rest the rifle on a steady support. Look through the bore from the breech (for actions other than bolt, you will need a small mirror, positioned in the ejection port and tilted so you can see through the bore, at a 50-yard target). Move the butt stock to center the target in the bore.

Without disturbing the rifle, adjust the windage and elevation knobs to center the reticle on target.

To raise the point of impact, turn the elevation knob counterclockwise. To shift the point of impact to the right, turn windage knob counterclockwise.

If large amounts of windage and elevation are needed to bore sight, make about 1/2 the required elevation change, then about 1/2 the windage. Finish by applying the balance of elevation correction and then windage.

NOTE: If you have windage adjustment rings, use them for major windage adjustments. Final adjustments are made with the windage and elevation knobs.

SCOPE MOUNT WINDAGE ADJUSTMENT

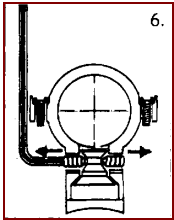

6. For windage adjustments, as one cone screw is loosened, the cone screw on the opposite side must be tightened to maintain tension on the stud (Fig.6). Adjust the opposing cone screws on the front or rear ring to align the vertical reticle crosshair with the bore sighted target. It is best to move each ring a

small amount alternately to keep the scope rings as near centered as possible. When rings are correctly positioned, tighten the cone screws.

If you are unable to bore sight, check the mounting system. Be sure you have the correct base and that it is properly attached to the rifle. Check the alignment of the base mounting holes in the receiver.

ZEROING

CAUTION: Zeroing should be done at an approved range or other safe area. Eye and ear protection is recommended.

DANGER: If you use a bore sighting collimator or any other bore obstructing device, remove it before proceeding further. If the barrel has been drilled for a mount, check that screws do not protrude into the bore. Do not fire live or even blank ammunition with an obstructed barrel. An obstruction can cause serious damage to the gun and possible personal injury to you or others nearby.

From a steady rest position, fire three rounds at a 100 yard target. Observe bullet strike on the target. Adjust the windage and elevation knobs as needed to correct the point of impact.

MAINTENANCE

Your ADCO Tactical Scope is shockproof, waterproof, and fog proof. However, you should never try to take it apart or clean it internally. If your scope ever needs repairs or adjustments, it should be returned to the ADCO Service Department. More complete instructions may be found in the warranty section.

The exposed optical surfaces will perform their best if they are occasionally wiped clean. Use the lens cloth

(included) with a drop of alcohol on it or an optical quality lens paper such as those used for eyeglasses or camera lenses. Keep the protective lens covers in place when you are not using the scope.

To maintain the lenses of your ADCO Tactical Scope, remove any dirt and/or sand with a soft brush so as to avoid scratching the lens. To maintain the metal surfaces, wipe down the scope with a damp cloth and follow with a dry cloth. Finally, wipe the tube using a silicone treated cloth to restore the luster and protect the scope. Be careful not to touch any of the lenses with the silicone cloth.



ADCO - Where performance is everything (sm)

ADCO SALES INC.

4 Draper Street

Woburn, MA 01801 U.S.A.

Tel. 781-935-1799

Fax 781-935-1011

www.adcosales.com - website

info@adcosales.com - e-mail