

## 2000-2002 High Pressure Regulator Assembly

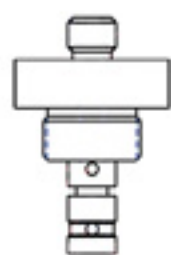

H-019 o-ring

982051

H-010 o-ring



935075



982052



63389

H-020 o-ring



982050



982038

H-015 UR o-ring



952076

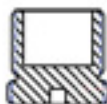

982039



982058

Press the 3/32 Dowel Pin into the Plunger 982038. Make sure the pin is straight and the pin has an overall length of 0.898 in. Place all O-Rings on designated pieces. Lightly lubricate the H-020 and H-019 o-rings on the reg body 982050 and reg adaptor 982051. Drop the regulator seal 63389 into the top bore of the regulator body 982050. Place the reg cup spring 935075 and the regulator cup 982052 inside the bore of the reg adaptor 982051. Make sure the cup portion of the regulator cup 982052 is facing out. Invert the reg body 982050 to screw the reg adaptor 982051 on so that the small cup and spring don't fall out. Use a small allen key and stick it through the bore in the regulator body 982050 so that it contacts the cup 982052. Push up and down and verify that the cup 982052 bounces freely. Lubricate the H-015 UR o-ring on the plunger 982038. Push the plunger 982038 into the bottom bore of the reg body 982050. Place the reg main spring 952076 into the adjustment screw 982039. Screw the adjustment screw into the bottom bore of reg body 982050, being careful not to cock the spring sideways. Wrap thread tape around the elbow threads and gauge threads. Put the elbow onto the input hole that has a small hole. Place the gauge onto the input hole that has a vertical line. After adjusting the regulator, replace foregrip 982058.



Elbow Side:

Notice the small hole in the center.



Gauge Side:

Notice the vertical line up the center.

**Remember: the gauge and elbow may not be switched!!!**