

# Raven PRIMAL Electronic Marker Parts List

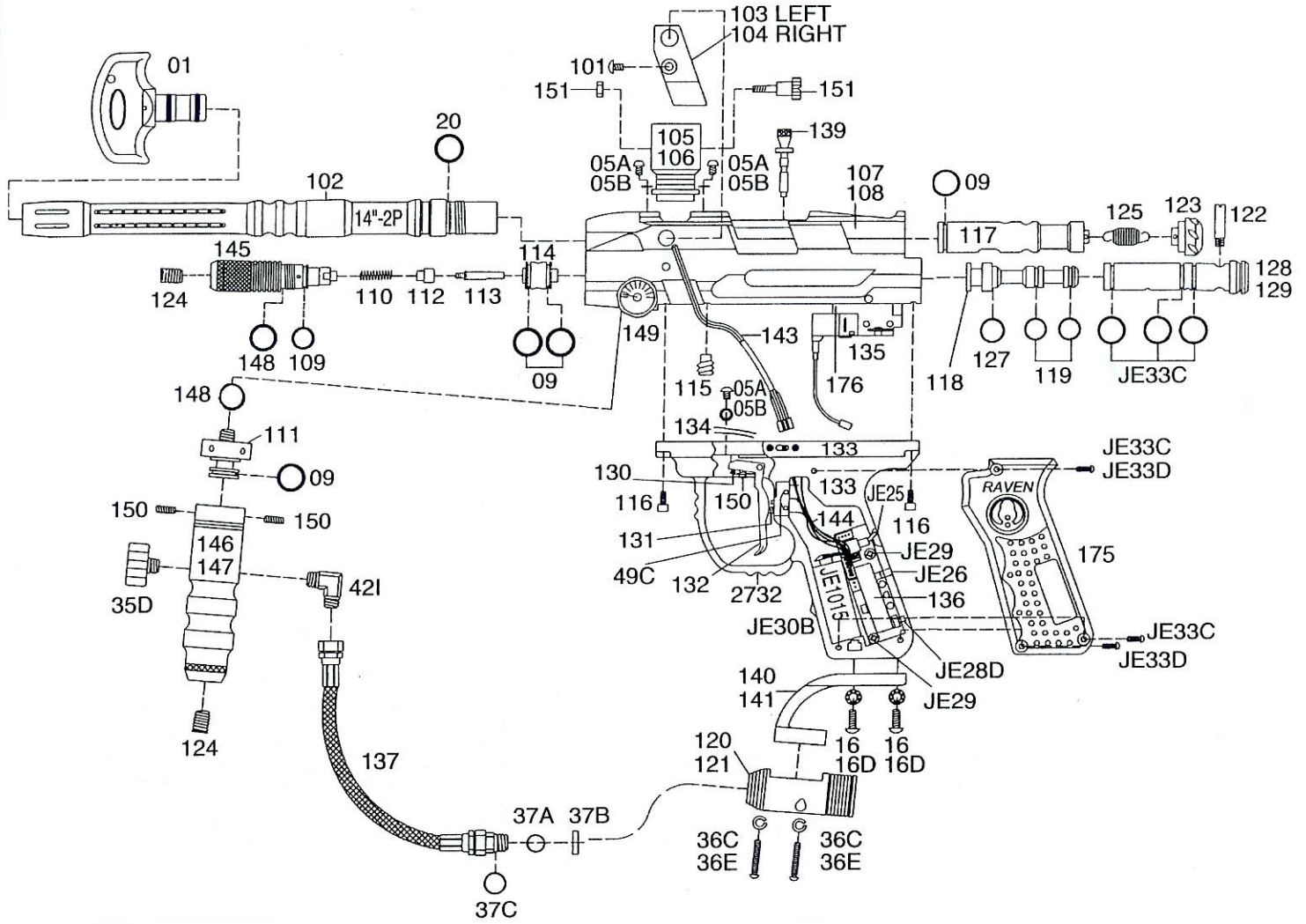

NEW ITEM #	NAME OF PARTS	NEW ITEM #	NAME OF PARTS
01	Barrel Plug	131	Micro Trigger
05A	M4 x 6 Screw (black)	132	Trigger
05B	M4 x 6 Screw (Silver)	133	Primal Trigger Frame
09	O-Ring #015 80D	134	Trigger Shim
16	M5 x 12 Screw (black)	135	Solenoid
16D	M5 X 12 Screw (silver)	136	Primal Circuit Board
20	Barrel O-Ring (black)	137	Disconnect Hose
101	Detent Cover Screw	138	On/Off Screw (M2 x 6 Screw)
102	14" Competition Barrel	139	Cocking Knob
103	Detent Cover (left panel)	140	Drop Forward (black)
104	Detent Cover (right panel)	141	Drop Forward (silver)
105	Direct Feed (black)	142	Spare Parts Kit
106	Direct Feed (silver)	143	Eye Wiring Harness
107	Receiver (black)	144	On/Off Switch w/ Wiring Harnesses
108	Receiver (silver)	145	Secondary Regulator (LPR)
109	O-ring #16 80D	146	Vertical Regulator (black)
110	Valve Spring	147	Vertical Regulator (silver)
111	Vertical Adaptor	148	O-ring #18 80D
112	Cup Seal	149	Low Pressure Gauge
113	Valve Pin	150	Major Trigger Adjust screw
114	Valve Body	151	Vertical Feed Screw w/ nut screw
115	Valve Body Screw	175	Rubber Grip Panel (black)
116	M35 x 12 Screw	176	Solenoid Gasket
117	Venturi Bolt	2732	Trigger Guard
118	Stainless Steel Striker	35D	Gauge
119	Striker O-ring #012 80D	36C	5/32" x 7/8" Screw (silver)
120	C/A Adaptor (silver)	36E	5/32" x 7/8" Screw (black)
121	C/A Adaptor (black)	37A	Filter O-Ring
122	pneumatic cylinder lock screw	37B	Air Filter
123	Bolt Plug	37C	Disconnect O-Ring #001 (black)
124	Regulator Adjust Screw	421	90d Male To Male Adaptor
125	Venturi Bolt Spring	49C	Touch Switch Roll Pin
126	Battery harness	JE1015	Java 9.6v Rechargeable Battery
127	O-ring #013 70D	JE29	Circuit Board Screw
128	Pneumatic Cylinder (black)	JE30B	Tournament Lock Switch
129	Pneumatic Cylinder (silver)	JE33C	Grip Cover Screw (silver)
130	Trigger Spring	JE33D	Grip Cover Screw (black)
		JE25	Chpper Eye On/Off Switch
		JE26	Charging Pin